

RESOLUTION OF FINAL PLAN SUBMITTAL FOR  
PROJECT NUMBER STBG-SWAP-C050(125)—FG-50

Moved by, Cupples seconded by, Talsma

To sign and approve Final Plans for a January 22, 2020 D.O.T Letting on project STBG-SWAP-C050(125)—FG-50, PCC overlay on a portion of F62 laying between IA 163 and IA 14 in Fairview West Township, Jasper County, Iowa.

AYES: Carpenter, Cupples, Talsma

NAYS: \_\_\_\_\_

Approved this 8th day of October, 2019.

Dennis Carpenter  
Dennis Carpenter  
Chairman Board of Supervisors

Brandon Talsma  
Brandon Talsma  
Board of Supervisors

Doug Cupples  
Doug Cupples  
Board of Supervisors

ATTEST: Dennis Parrott  
Dennis Parrott  
Jasper County Auditor

**LEGEND**

- DIVIDED HIGHWAY
- PAVED ROAD
- BITUMINOUS ROAD
- GRAVEL ROAD
- EARTH ROAD
- INTERSTATE HIGHWAY
- UNITED STATES HIGHWAY
- COUNTY HIGHWAY
- RAILROAD
- AIRPORT
- HYDROLOGY BRIDGE
- STATE BOUNDARY
- COUNTY BOUNDARY
- TOWNSHIP LINE
- SECTION LINE

DESIGN DATA	
2018 AADT	670 VPD
2038 AADT	1300 VPD
DESIGN SPEED	60 MPH
TRUCKS	20%

CONTACT INFORMATION  
 JASPER COUNTY ENGINEER'S OFFICE  
 910 N 11TH AVE E  
 NEWTON, IA 50208  
 PHONE: 641.792.5862  
 FAX: 641.791.7740

**JASPER COUNTY**  
 STBG-SWAP-C050(125)--FG-50  
**PCC OVERLAY-UNBONDED**  
 Located on Highway F-62 from Iowa Highway 163  
 easterly 4.15 miles to Iowa Highway 14

**INDEX OF SHEETS**

NO.	TITLE SHEET	DESCRIPTION
A-01	GENERAL NOTES AND QUANTITIES TABULATIONS	
B-01-B-03	TYPICAL CROSS SECTIONS AND DETAILS	
C-01-C-06	TRAFFIC CONTROL PLAN	
D-01-D-02	12 SHEETS	
TOTAL		

**MILEAGE SUMMARY**

DIV.	LOCATION	END STA.	START STA.	LIN. FT.	MILES
1	BGN. STA. 10+90	230+23	21993.00	21993.00	4.15
	BGN. STA. 10+90	230+23	21993.00		4.15

**JASPER COUNTY BOARD OF SUPERVISORS**

Supervisor	DATE
Supervisor	DATE
Supervisor	DATE

**STANDARD ROAD PLANS**

THE FOLLOWING STANDARD PLANS SHALL BE CONSIDERED APPLICABLE TO CONSTRUCTION WORK ON THIS PROJECT

STANDARD	TITLE
PM-120	STOP LINES & ISLANDS
PIV-101	JOINTS
TC-202	SHOULDER CLOSURE
TC-202	ROAD CLOSURE

REFER TO THE PROPOSAL FORM FOR LIST OF APPLICABLE SPECIFICATIONS

**TRAFFIC CONTROL PLAN**

THIS ROAD SHALL BE CLOSED TO TRAFFIC DURING PAVING CONSTRUCTION. ROAD CLOSURES SHALL BE CHANGED TO "ROAD CLOSED TO THRU TRAFFIC" AS SOON AS PAVEMENT REACHES MATURITY AND SHOULDER DROPOFF IS ADDRESSED. CONTRACTOR SHALL FURNISH, ERECT, AND MAINTAIN DETOUR SIGNS, TRAFFIC CONTROL SIGNS, AND TRAFFIC CONTROL DEVICES. ROAD CLOSURE TO THRU TRAFFIC SIGNS MOUNTED ON TYPE III BARRICADES, ROAD CLOSED TO THRU TRAFFIC SIGNS MOUNTED ON TYPE III BARRICADES, AND SAFETY FENCE AT SAFETY CLOSURE LOCATIONS. LOCAL TRAFFIC TO ADJACENT PROPERTIES SHALL BE MAINTAINED AS PROVIDED FOR IN ARTICLE 1197.08 OF THE STANDARD SPECIFICATIONS FOR CONSTRUCTION OF HIGHWAYS AND BRIDGES. THE STANDARD SPECIFICATIONS FOR TRAFFIC CONTROL DEVICES, PROCEDURES, LAYOUTS, SIGNING, AND PAVEMENT MAINTENANCE SHALL BE THE STANDARD SPECIFICATIONS FOR TRAFFIC CONTROL DEVICES FOR STREETS AND HIGHWAYS AS ADOPTED BY THE DEPARTMENT PER 781 OF THE IOWA CHAPTER 130.

I HEREBY CERTIFY THAT THIS ENGINEERING DOCUMENT WAS PREPARED BY ME OR UNDER MY DIRECT PERSONAL SUPERVISION AND THAT I AM A DULY LICENSED PROFESSIONAL ENGINEER UNDER THE LAWS OF THE STATE OF IOWA.

BY: \_\_\_\_\_ DATE: \_\_\_\_\_

RUSSELL A. STUTT, P.E. 18165  
 MY LICENSE RENEWAL DATE IS DEC. 31, 2020

(ENTIRE SUBMISSION UNLESS SPECIFIED HERE)

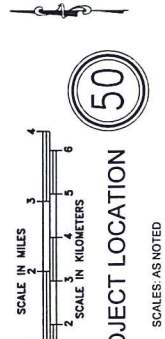
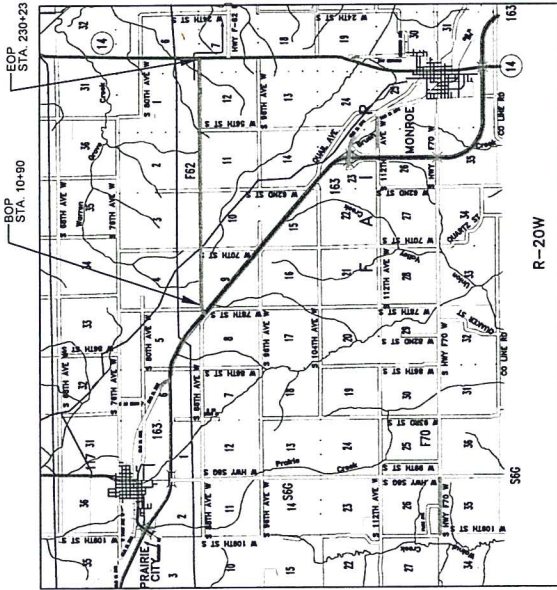
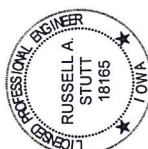

**UTILITY CONTACT INFORMATION**

UTILITY COMPANY NAME	PHONE	ADDRESS
(A) IAT&T TRANSMISSION	8162754014	1802 SE Delaware Ave, Suite 114, Ankeny, IA 50021
(C) IOWA REGIONAL UTILITY ASSOC	6417927011	1351 Iowa Speedway Dr, Newton, IA 50208
(I) IADJCENTURLINK	7205786090	135 E Main St, Marshalltown, IA 50158
(I) IOWA COMMUNICATIONS NETWORK	8005723940	Grimes Building, 400 E 14th St, Des Moines, IA 50319
(M) M/DAMER-ELEC	5152526632	2411 N Market St, Okaloosa, IA 52577
(M) M/DAMER-ELEC	5152526632	2411 N Market St, Okaloosa, IA 52577
(M) M/DAMER-ELEC	5152526632	2411 N Market St, Okaloosa, IA 52577
(M) M/DAMER-FIBER	5152812313	2411 N Market St, Okaloosa, IA 52577
(N) NORTHERN NATURAL GAS COMPANY	5152025067	6751 Merle Hwy Rd, Johnston, IA 50131
(O) NORTHERN SYSTEM L.L.C.	5803956316	3114 Main Ave, Clear Lake, IA 50428
(W) WINDSTREAM COMMUNICATIONS	8003891901	3540 SW 61st St, Des Moines, IA 50321

THE CONTRACTOR IS REQUIRED TO CONTACT "ONE CALL" AT (800) 292-8889 TO OBTAIN LOCATIONS FOR ALL EXISTING UTILITIES.



**ESTIMATED PROJECT QUANTITIES**

NO.	EM-CODE	ITEM	UNIT	QUANTITY
1	4115-0100000	MODIFIED SUBBASE	CY	224.00
2	2121-7425020	GRANULAR SHOULDER, TYPE B	ONS	11507.30
3	2213-7100400	RELOCATION OF MAIL BOX	EACH	1
4	2301-1034090	SID OR SLIP FORM PCC PAVEMENT, CLASS C, CLASS 3I DURABILITY, 9 IN	SY	3636.22
5	2310-5151040	PORTLAND CEMENT CONCRETE OVERLAY, FURNISH ONLY	CY	13260.59
6	2310-5151045	PORTLAND CEMENT CONCRETE OVERLAY, PLACEMENT ONLY	SY	65216.87
7	2310-8300850	PAVEMENT INTERLAYER GEOTEXTILE	SY	57333.33
8	2510-6745850	REMOVAL OF PAVEMENT	SY	1318.22
9	2515-2475006	DRIVEWAY, PCC, 6"	SY	69.00
10	2515-6745800	REMOVAL OF PAVED DRIVEWAY	SY	69.00
11	2518-6910000	SAFETY CLOSURE	EACH	8
12	2526-8285000	CONSTRUCTION SURVEY	LS	1
13	2527-9263117	PAINTED PAVEMENT MARKINGS, DURABLE	STA	656.50
14	2527-9270111	GROOVES CUT FOR PAVEMENT MARKINGS	STA	656.50
15	2528-8646110	TRAFFIC CONTROL	LS	1
16	2529-5070120	PATCH, FULL-DEPTH FINISH, BY AREA	SY	948.69
17	2533-5070120	PATCH, FULL-DEPTH FINISH, BY COUNT	EACH	165
18	2533-4980005	MOBILIZATION	LS	1

**GENERAL NOTES**

- THE CONTRACTOR SHALL CONTAIN ALL WORK TO THE EXISTING RIGHT OF WAY UNLESS WRITTEN PERMISSION IS OBTAINED FROM PERSPECTIVE PROPERTY OWNER AND PRESENTED TO THE CONTRACTING AUTHORITY.
- ALL RUBBLE AND DEBRIS GENERATED BY REMOVAL CONSTRUCTION OPERATIONS SHALL BE CLEANED UP AND DISPOSED OF BY THE CONTRACTOR IN COMPLIANCE WITH APPLICABLE FEDERAL, STATE, AND LOCAL REQUIREMENTS.
- ANY EXISTING FIELD TILE THAT IS DISTURBED DURING CONSTRUCTION SHALL BE REPLACED OR REPAIRED TO FUNCTION AS WELL OR BETTER THAN ORIGINAL BY THE CONTRACTOR AT THEIR EXPENSE.
- IT WILL BE THE CONTRACTOR'S RESPONSIBILITY TO NOTIFY ALL UTILITIES ON THIS PROJECT PRIOR TO BEGINNING WORK, AS PER ARTICLE 1107.5 OF THE STANDARD SPECIFICATIONS.
- STANDARD SPECIFICATION SECTIONS ASSOCIATED WITH ITEM CODES SHALL APPLY UNLESS OTHERWISE NOTED.
- 911 SIGNS SHALL NOT BE DISTURBED UNLESS THEY INTERFERE WITH CONSTRUCTION. DISTURBED 911 SIGNS SHALL BE REPLACED BY OTHERS.
- A PLAN FOR STAGE CONSTRUCTION OF LOCAL ACCESSES WHICH ARE REQUIRED TO REMAIN OPEN TO TRAFFIC DURING CONSTRUCTION SHALL BE SUBMITTED BY THE CONTRACTOR FOR APPROVAL BY THE ENGINEER PRIOR TO CONSTRUCTION.
- CONTRACTOR SHALL NOTIFY COUNTY 3 WEEKS PRIOR TO STARTING CONSTRUCTION. CONTRACTOR SHALL TAKE CARE NOT TO DISTURB OR DESTROY CONTROL POINTS SET ON THE PROJECT.

**ESTIMATE REFERENCE INFORMATION**

NO.	BID ITEM NOTES
2	SHOULDER QUANTITY CALCULATED AT 150W/C.F. GRADATION #11 FOR CLASS A STONE SHALL APPLY. AGGREGATE SHALL CONTAIN SUFFICIENT MOISTURE TO OBTAIN COMPACTION. SHOULDER MATERIAL SHALL BE PLACED IN TWO LIFTS. RUBBER TIRED ROLLERS SHALL BE USED TO COMPACT FIRST LIFT. SMOOTH DRUM ROLLER SHALL BE USED FOR FINAL COMPACTION. QUANTITY INCLUDES MATERIAL FOR 14 ENTRANCES (SEE TABULATION JAS-17 ON SHEET B.02 FOR QUANTITIES) AND 8 SIDE ROADS (SEE INTERSECTION DETAIL SHEETS FOR QUANTITIES). MATERIAL MUST BE FROM AN DOT CERTIFIED SOURCE. THE CONTRACTOR SHALL COORDINATE PAVING AND SHOULDERING OPERATIONS. A MAXIMUM OF 3 MILES OF MATURED MAINLINE PAVEMENT WILL BE ALLOWED WITHOUT PLACING GRANULAR SHOULDERS.
3	CONTRACTOR TO REMOVE AND RESET, ACCORDING TO U.S. POSTAL REQUIREMENTS, ANY MAILBOXES AS NECESSARY. TEMPORARY PLACEMENT OF MAILBOXES DURING STAGED CONSTRUCTION SHALL BE COMPLETED PRIOR TO THE CONTRACT START DATE. MAILBOXES ON SAME POST COUNT AS ONE MAILBOX. MAILBOXES WITH MULTIPLE POSTS COUNT AS ONE MAILBOX. SEE TABULATION JAS-30 ON SHEET B.02.
4	CLASS C MIX WITH CLASS 3I DURABILITY SHALL BE USED. STRENGTH OF PCC USING MATURITY METHOD SHALL APPLY. MATURITY CURVE SHALL BE ESTABLISHED BEFORE START OF PAVING. CERTIFIED PLANT INSPECTION SPECIFICATION 2521 SHALL APPLY. PAVEMENT SMOOTHNESS SPECIFICATION 2316 SHALL APPLY. THERE WILL BE NO GRINDING OF NEW PCC UNLESS APPROVED BY PROJECT ENGINEER. L-JOINT SHALL BE PLACED AT CENTERLINE. SKEWED TRANSVERSE "C" JOINTS SHALL BE AS PER ROAD STANDARD PV-101 AT 12' SPACINGS. PERPENDICULAR TRANSVERSE JOINTS WILL BE ALLOWED AT INTERSECTIONS AS SHOWN OR AS APPROVED BY THE ENGINEER.
5 & 6	CONCRETE SHALL BE CLASS C MIX WITH CLASS 3I DURABILITY. FURNISH ONLY QUANTITY FIGURED AT 7" WITH 7% OVERRUN FOR OVERLAY WITH 530.88 CY ADDED FOR ADDED THICKNESS TO EDGE OF SLAB. PLACE ONLY QUANTITY FIGURED WITH A 5% OVERRUN FOR CURING MATURITY METHOD. MATURITY CURVE SHALL BE ESTABLISHED BEFORE START OF CONSTRUCTION. STRENGTH OF PCC SHALL BE PLACED ON MAINLINE & SIDEROADS. SKEWED TRANSVERSE "C" JOINTS SHALL BE PLACED AS PER ROAD STANDARD PV-101 AT 12' SPACINGS. PERPENDICULAR TRANSVERSE JOINTS WILL BE ALLOWED AT INTERSECTIONS UPON APPROVED INTERSECTION JOINT LAYOUT SUBMITTED BY CONTRACTOR. PAVEMENT SMOOTHNESS SECTION 2316 SHALL APPLY. THERE WILL BE NO GRINDING OF NEW PCC UNLESS APPROVED BY PROJECT ENGINEER. SKEWED TRANSVERSE JOINTS SHALL BE PLACED AT CENTERLINE. SKEWED TRANSVERSE "C" JOINTS SHALL BE AS PER ROAD STANDARD PV-101 AT 12' SPACINGS. PERPENDICULAR TRANSVERSE JOINTS WILL BE ALLOWED AT INTERSECTIONS AS SHOWN OR AS APPROVED BY THE ENGINEER. EXCESS SHOULDER MATERIAL SHALL BE PLACED ON FORESLOPE BLADING AND SHAPING OF SHOULDERS IS INCIDENTAL TO THIS ITEM.
7	CONTRACTOR SHALL USE 16 OZ./SQ. YD. FABRIC. REFER TO DS-15082.
8	SEE TABULATION JAS-17 ON SHEET B.02 FOR LOCATIONS. CONTRACTOR SHALL BE RESPONSIBLE FOR REMOVING AND DISPOSING OF EXISTING PAVEMENT ACCORDING TO SECTION 1104.08 OF THE STANDARD SPECIFICATIONS. SAW CUTS FOR REMOVAL SHALL BE CONSIDERED INCIDENTAL. EXISTING PAVEMENT THICKNESS IS ESTIMATED TO BE 7", BUT MAY VARY.
9	SEE TABULATION JAS-17 ON SHEET B.02 FOR LOCATIONS AND QUANTITIES. SEE SHEETS C.09-C.10 FOR JOINT DETAILS.
10	SEE TABULATION JAS-17 ON SHEET B.02 FOR LOCATIONS. CONTRACTOR SHALL BE RESPONSIBLE FOR REMOVING AND DISPOSING OF EXISTING PAVEMENT ACCORDING TO SECTION 1104.08 OF THE STANDARD SPECIFICATIONS. SAW CUTS FOR REMOVAL SHALL BE CONSIDERED INCIDENTAL.
11	SEE TABULATION JAS-10 ON SHEET B.02 FOR LOCATIONS. ROAD SAFETY CLOSURES SHALL BE FURNISHED & PLACED BY CONTRACTOR AT BOTH ENDS OF PROJECT & SIDEROADS, AS PER ROAD STANDARD TC-282. CONTRACTOR SHALL BE RESPONSIBLE FOR MAINTAINING ROAD SAFETY CLOSURES.
12	STRINGLESS PAVING IS ENCOURAGED BUT NOT REQUIRED. JASPER COUNTY WILL CREATE A MODEL OF THE EXISTING PROFILE AND PROPOSED PAVEMENT SURFACE FOR STRINGLESS PAVING. JASPER COUNTY WILL PROVIDE CONTROL POINTS/BENCHMARKS TO BE USED FOR STRINGLESS PAVING. JASPER COUNTY WILL SET LATH TO MARK STATIONING AT 500' INTERVALS. JASPER COUNTY WILL BE RESPONSIBLE FOR PRESERVATION OF EXISTING SECTION CORNERS AND QUARTER CORNERS. ITEM SHALL INCLUDE STAKING PAVEMENT (INCLUDING INTERSECTIONS) NOT COMPLETED BY STRINGLESS PAVING.
13	ITEM CONSISTS OF YELLOW AND WHITE PAVEMENT MARKINGS. SEE SHEET D.02 FOR DETAILS. DOUBLE CENTERLINE MARKINGS SHALL BE SPACED AT 8'. CONTRACTOR SHALL FURNISH MATERIAL CERTIFIED TO MEET THE REQUIREMENTS OF THE ENGINEER BEFORE PLACING PAVEMENT MARKINGS. STOP LINES SHALL BE PLACED AT 8' O.P.F. AND E.O.P. AS PER ROAD STANDARD PM-120.
15	SEE TRAFFIC CONTROL PLAN ON SHEET D.01 FOR DETAILS. CONSTRUCTION SHALL BE STAGED SO THAT RESIDENTS ALONG THE SUBJECT ROUTE WILL HAVE ACCESS TO THEIR HOMES AND DRIVEWAYS DAILY (SEE TABLE JAS-17 FOR DRIVEWAY LOCATIONS). IN THE EVENT OF STAGING, CONTRACTOR MAY PROVIDE LIGHT VEHICLES (E.G. GOLF CARTS OR ATVs) TO ENSURE ACCESS PRIOR TO OPENING THE PAVEMENT TO LOCAL TRAFFIC. NO EXTRA PAYMENT WILL BE MADE IF THE ALTERNATIVE IS SELECTED.
16 & 17	THIS ITEM SHALL INCLUDE PCC PATCHES AS SHOWN IN TABULATION 102-5C ON SHEET B.03. PATCHES SHALL BE PLACED USING M-4 MIX. LOCATIONS WILL BE MARKED BY JASPER COUNTY AT THE TIME OF CONSTRUCTION.

JASPER COUNTY ENGINEERING DEPARTMENT	
DESIGN FOR	
<b>PCC OVERLAY - UNBONDED</b>	
<b>GENERAL NOTES AND</b>	
<b>QUANTITIES TABULATIONS</b>	
DESIGNED BY	JL 7-22-19
DATE REVISION	JL 9-12-19
PROJECT NO.	STBG-SWAP-C050(125)--FG-50

STBG-SWAP-C050(125)--FG-50

JASPER COUNTY

PCC OVERLAY-UNBONDED

SHEET B.01



**ENTRANCES**

LOCATION	DRIVEWAY SURFACE AREA		DRIVEWAY SURFACE MATERIAL	REMARKS
	HMA	PCC		
18+05	R	7	HOUSE NO. 7653	
18+75	R	7	HOUSE NO. 7653	
35+00	R	7	HOUSE NO. 7361	
64+93	L	7	HOUSE NO. 6958	
64+93	L	7	HOUSE NO. 6530	
104+00	L	69	HOUSE NO. 8817	
111+25	R	7	HOUSE NO. 5493	
189+84	R	7	HOUSE NO. 5316	
173+17	L	7	HOUSE NO. 4827	
192+00	L	7	HOUSE NO. 4716	
195+40	L	7	HOUSE NO. 4716	
213+23	L	7	HOUSE NO. 4157	
222+81	L	7	HOUSE NO. 3852	

**SAFETY CLOSURES**

Refer to Section 2115 for the Standard Specifications

LOCATION	SIDE	EACH	REMARKS
BOP		1	ROAD CLOSURE REFER TO IC-282
W70N S/S	Left	1	ROAD CLOSURE REFER TO IC-282
W70N S/S	Both	2	ROAD CLOSURE REFER TO IC-282
W62N S/S	Both	2	ROAD CLOSURE REFER TO IC-282
W70N S/S	Right	1	ROAD CLOSURE REFER TO IC-282
BOP		1	ROAD CLOSURE REFER TO IC-282
Totals		8	

**TABULATION OF MAILBOX RELOCATION**

STATION	911 ADDRESS	QUANTITY	REMARKS
18+05	HOUSE NO. 7653	1	
35+00	HOUSE NO. 7361	1	
63+80	HOUSE NO. 6646	1	
94+93	HOUSE NO. 6460	1	
104+00	HOUSE NO. 6320	1	
189+84	HOUSE NO. 5493	1	
173+17	HOUSE NO. 5316	1	
192+00	HOUSE NO. 4976	1	
195+40	HOUSE NO. 4976	1	
213+23	HOUSE NO. 4157/4162	2	
222+81	HOUSE NO. 3852	1	

**REMOVAL OF PAVEMENT & PAVED DRIVEWAYS**

STATION TO STATION	SIDE	SQ. YDS.	SAW CUT	REMARKS
10+30	BOTH	529.78	2	BOP
104+00	LEFT	69.00	1	Asphalt Driveway
228+00	BOTH	788.44	2	EOP (includes radii)

**CONTROL POINTS**

Control points are 5'ft' rebar with orange control point cap

Point #	Nothing	Easting	Elev.	Nothing	Easting	Elev.
1001	57613.270	173051.920	921.490			
1002	57613.270	173051.920	925.340			
1003	57613.270	173051.920	929.540			
1004	57613.270	173051.920	934.250			
1005	57613.270	173051.920	939.510			
1006	57613.270	173051.920	945.340			
1007	57613.270	173051.920	951.760			
1008	57613.270	173051.920	958.800			
1009	57613.270	173051.920	966.480			
1010	57613.270	173051.920	974.830			
1011	57613.270	173051.920	983.890			
1012	57613.270	173051.920	993.700			
1013	57613.270	173051.920	1004.300			
1014	57613.270	173051.920	1015.750			
1015	57613.270	173051.920	1028.000			
1016	57613.270	173051.920	1041.100			
1017	57613.270	173051.920	1055.100			
1018	57613.270	173051.920	1070.000			
1019	57613.270	173051.920	1085.800			
1020	57613.270	173051.920	1102.500			
1021	57613.270	173051.920	1120.100			
1022	57613.270	173051.920	1138.600			
1023	57613.270	173051.920	1158.000			
1024	57613.270	173051.920	1178.300			
1025	57613.270	173051.920	1199.500			
1026	57613.270	173051.920	1221.600			
1027	57613.270	173051.920	1244.600			
1028	57613.270	173051.920	1268.500			
1029	57613.270	173051.920	1293.300			
1030	57613.270	173051.920	1319.000			
1031	57613.270	173051.920	1345.600			
1032	57613.270	173051.920	1373.100			
1033	57613.270	173051.920	1401.500			
1034	57613.270	173051.920	1430.800			
1035	57613.270	173051.920	1461.000			
1036	57613.270	173051.920	1492.100			
1037	57613.270	173051.920	1524.100			
1038	57613.270	173051.920	1557.000			
1039	57613.270	173051.920	1590.800			
1040	57613.270	173051.920	1625.500			
1041	57613.270	173051.920	1661.100			
1042	57613.270	173051.920	1697.600			
1043	57613.270	173051.920	1735.000			
1044	57613.270	173051.920	1773.300			
1045	57613.270	173051.920	1812.500			
1046	57613.270	173051.920	1852.600			
1047	57613.270	173051.920	1893.600			
1048	57613.270	173051.920	1935.500			
1049	57613.270	173051.920	1978.300			
1050	57613.270	173051.920	2022.000			
1051	57613.270	173051.920	2066.700			
1052	57613.270	173051.920	2112.400			
1053	57613.270	173051.920	2159.100			
1054	57613.270	173051.920	2206.800			
1055	57613.270	173051.920	2255.500			
1056	57613.270	173051.920	2305.200			
1057	57613.270	173051.920	2355.900			
1058	57613.270	173051.920	2407.600			
1059	57613.270	173051.920	2460.300			
1060	57613.270	173051.920	2514.000			
1061	57613.270	173051.920	2568.700			

**PAVEMENT MARKINGS**

STATION TO STATION	SIDE		①	②	③	④	REMARKS
	Left	Right					
10+31	X	X					
11+68	X	X					
87+10	X	X					
94+57	X	X					
96+93	X	X					
98+84	X	X					
102+00	X	X					
103+75	X	X					
110+35	X	X					
111+37	X	X					
120+51	X	X					
145+08	X	X					
153+68	X	X					
161+82	X	X					
181+82	X	X					
172+05	X	X					
178+35	X	X					
184+25	X	X					
185+24	X	X					
205+65	X	X					
220+66	X	X					
230+36	X	X					
10+21	X	X					
<b>SUBTOTALS</b>							
<b>TOTALS</b>							
<b>QUANTITY FACTORS</b>							
<b>TOTALS</b>							

JAS-18  
7/18/17

JASPER COUNTY ENGINEERING DEPARTMENT  
DESIGN FOR  
**PCC OVERLAY - UNBONDED**  
**GENERAL NOTES AND**  
**QUANTITIES TABULATIONS**

DATE REVISED: JL 7-22-19  
PROJECT NO: STBG-SWAP-C050(125)--FG-50

STBG-SWAP-C050(125)--FG-50  
JASPER COUNTY  
PCC OVERLAY-UNBONDED

SHEET B.02



Count	Location		Lane (L,R or B)	Dimension			PCC Patches			'BT' Joints (No.)	'CT' Joints (No.)	'EF' Joints (No.)	Remarks
	Station	Station		Length (Feet)	Width (Feet)	Patch Thickness (Inches)	With Dowels (Sq. Yds.)	Without Dowels (Sq. Yds.)	C R C (Sq. Yds.)				
2	13+96	B	4	22	8	9.78	9.78		2	1			
2	18+27	B	3	22	8	7.33	7.33		2	1			
2	18+66	B	3	22	8	7.33	7.33		2	1			
2	19+05	B	4	22	8	9.78	9.78		2	1			
2	19+44	B	4	22	8	9.78	9.78		2	1			
1	19+82	L	3	11	8	3.67	3.67		3				
1	20+39	L	3	11	8	3.67	3.67		3				
1	20+97	L	5	11	8	11.11	11.11		3				
1	21+39	L	4	11	8	4.89	4.89		3				
1	22+95	L	4	11	8	4.89	4.89		3				
2	29+10	R	5	11	8	11.11	11.11		3				
2	32+13	B	4	22	8	9.78	9.78		2	1			
2	35+69	B	4	22	8	9.78	9.78		2	1			
2	38+09	B	4	22	8	9.78	9.78		2	1			
2	38+47	B	3	22	8	7.33	7.33		2	1			
1	39+58	L	3	11	8	3.67	3.67		3				
1	39+97	R	3	11	8	3.67	3.67		3				
2	39+53	B	3	22	8	7.33	7.33		2	1			
1	41+44	L	4	11	8	4.89	4.89		3				
1	42+24	R	3	11	8	3.67	3.67		3				
1	45+66	L	22	11	8	26.89	26.89		2	1			
1	45+86	R	4	22	8	9.78	9.78		2	1			
2	47+12	B	4	22	8	9.78	9.78		2	1			
2	47+56	L	4	11	8	4.89	4.89		3				
2	48+14	B	4	22	8	9.78	9.78		2	1			
2	50+75	B	5	22	8	12.22	12.22		2	1			
2	52+36	B	5	22	8	12.22	12.22		2	1			
1	53+11	L	4	11	8	4.89	4.89		3				
1	54+27	R	4	11	8	4.89	4.89		3				
2	54+65	B	5	22	8	12.22	12.22		2	1			
2	55+87	B	5	22	8	12.22	12.22		2	1			
2	58+66	B	4	22	8	9.78	9.78		2	1			
2	65+40	L	17	11	8	20.78	20.78		3				
2	71+43	B	4	22	8	9.78	9.78		2	1			
2	74+55	B	3	22	8	7.33	7.33		2	1			
2	75+78	B	4	22	8	9.78	9.78		2	1			
1	81+20	L	15	11	8	18.33	18.33		3				
1	85+60	R	4	11	8	4.89	4.89		3				
1	89+07	L	4	11	8	4.89	4.89		3				
1	89+50	R	4	11	8	4.89	4.89		3				
2	89+87	B	5	22	8	12.22	12.22		2	1			
1	90+63	L	4	11	8	4.89	4.89		3				
1	93+36	R	5	11	8	6.11	6.11		3				
1	105+50	L	7	11	8	8.56	8.56		3				
1	105+50	R	3	11	8	3.67	3.67		3				
2	108+30	B	4	22	8	9.78	9.78		2	1			
1	120+67	L	15	11	8	18.33	18.33		3				
2	152+55	B	3	22	8	7.33	7.33		2	1			
1	152+97	L	4	11	8	4.89	4.89		3				
2	153+37	B	3	22	8	7.33	7.33		2	1			
2	160+59	B	4	22	8	9.78	9.78		2	1			
2	161+33	B	3	22	8	7.33	7.33		2	1			
2	161+72	B	4	22	8	9.78	9.78		2	1			
2	162+51	B	5	22	8	12.22	12.22		2	1			
1	163+26	R	4	11	8	4.89	4.89		3				
1	165+28	R	4	11	8	4.89	4.89		3				
1	166+45	L	4	11	8	4.89	4.89		3				
1	169+25	R	6	11	8	7.33	7.33		3				
1	172+42	L	4	11	8	4.89	4.89		3				
1	181+49	R	6	11	8	7.33	7.33		3				
2	182+20	B	4	22	8	9.78	9.78		2	1			
2	182+30	B	4	22	8	9.78	9.78		2	1			
1	182+70	R	4	11	8	4.89	4.89		3				
2	183+51	B	3	22	8	7.33	7.33		2	1			
2	184+48	B	4	22	8	9.78	9.78		2	1			
1	188+42	L	3	11	8	3.67	3.67		3				
2	192+90	B	5	22	8	12.22	12.22		2	1			

Count	Location		Lane (L,R or B)	Dimension			PCC Patches			'BT' Joints (No.)	'CT' Joints (No.)	'EF' Joints (No.)	Remarks
	Station	Station		Length (Feet)	Width (Feet)	Patch Thickness (Inches)	With Dowels (Sq. Yds.)	Without Dowels (Sq. Yds.)	C R C (Sq. Yds.)				
1	194+50	L	6	11	8	7.33	7.33		3				
1	194+50	L	3	11	8	3.67	3.67		3				
2	195+73	B	3	22	8	7.33	7.33		2	1			
2	196+96	B	4	22	8	9.78	9.78		2	1			
2	198+18	B	4	22	8	9.78	9.78		2	1			
2	198+97	B	5	22	8	12.22	12.22		2	1			
1	199+37	R	4	11	8	4.89	4.89		3				
2	199+75	B	5	22	8	12.22	12.22		2	1			
1	200+06	L	15	11	8	18.33	18.33		3				
2	201+38	R	3	22	8	7.33	7.33		2	1			
2	204+91	B	4	11	8	4.89	4.89		3				
1	205+29	R	5	11	8	6.11	6.11		3				
2	205+68	B	3	22	8	7.33	7.33		2	1			
1	205+06	R	4	11	8	4.89	4.89		3				
2	214+72	B	4	22	8	9.78	9.78		2	1			
2	219+33	B	4	22	8	9.78	9.78		2	1			
1	219+85	L	6	11	8	7.33	7.33		3				
2	220+76	B	3	22	8	7.33	7.33		2	1			
1	221+12	R	5	11	8	6.11	6.11		3				
2	221+30	B	8	22	8	19.56	19.56		2	1			
2	221+94	B	6	22	8	14.67	14.67		2	1			
2	222+15	B	6	22	8	14.67	14.67		2	1			
1	222+32	B	8	22	8	19.56	19.56		2	1			
2	222+69	L	3	11	8	3.67	3.67		3				
2	233+06	B	4	22	8	9.78	9.78		2	1			
2	233+62	B	4	22	8	9.78	9.78		2	1			
2	244+56	B	4	22	8	9.78	9.78		2	1			
2	244+95	B	4	22	8	9.78	9.78		2	1			
2	253+31	B	6	22	8	14.67	14.67		2	1			
2	253+44	B	3	22	8	7.33	7.33		2	1			
1	253+67	B	5	22	8	12.22	12.22		2	1			
2	253+86	L	3	11	8	3.67	3.67		3				
2	258+43	B	5	22	8	12.22	12.22		2	1			
2	258+48	B	3	22	8	7.33	7.33		2	1			
2	257+18	B	3	22	8	7.33	7.33		2	1			
2	262+48	B	4	22	8	9.78	9.78		2	1			

JASPER COUNTY ENGINEERING DEPARTMENT  
DESIGN FOR  
PCC OVERLAY - UNBONDED  
GENERAL NOTES AND  
QUANTITIES TABULATIONS  
PROJECT NO. JL 7-26-19 LAST REVISION JL 9-12-19

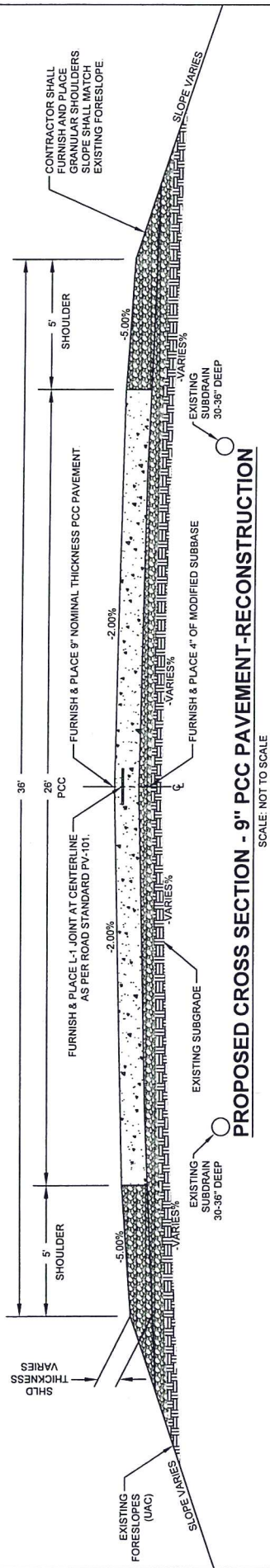
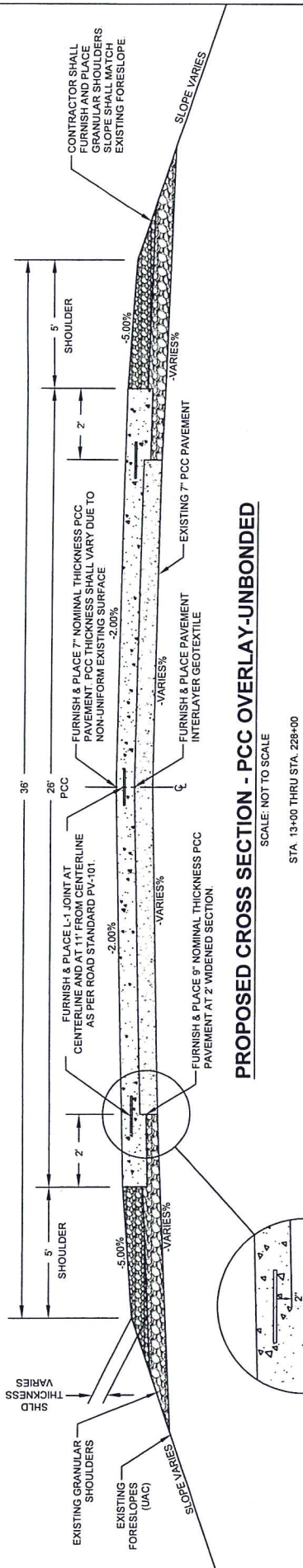

JASPER COUNTY ENGINEERING DEPARTMENT	
DESIGN FOR	
<b>PCC OVERLAY - UNBONDED</b>	
<b>TYPICAL CROSS SECTIONS AND DETAILS</b>	
DESIGNED BY	DATE REVISION
JL 06-14-19	JL 06-14-19
PROJECT NO. STBG-SWAP-C050(125)-FG-50	



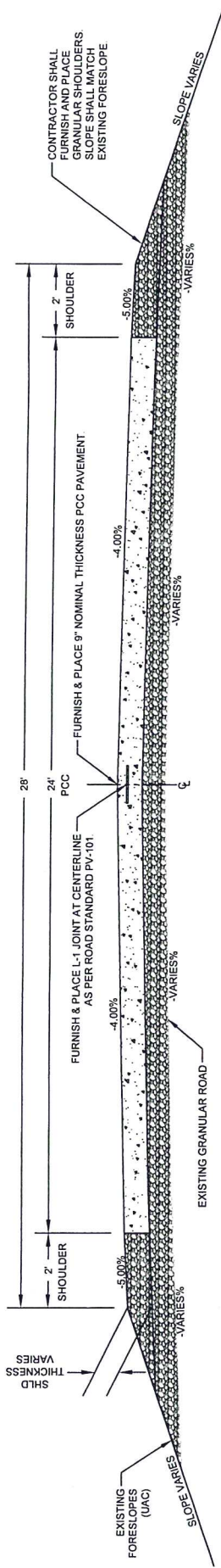

**PROPOSED CROSS SECTION - 9" PCC PAVEMENT**

SCALE: NOT TO SCALE

FOR RUN-OUTS AT GRANULAR SIDE ROADS  
SEE SHEETS C.03-C.08 FOR LOCATIONS

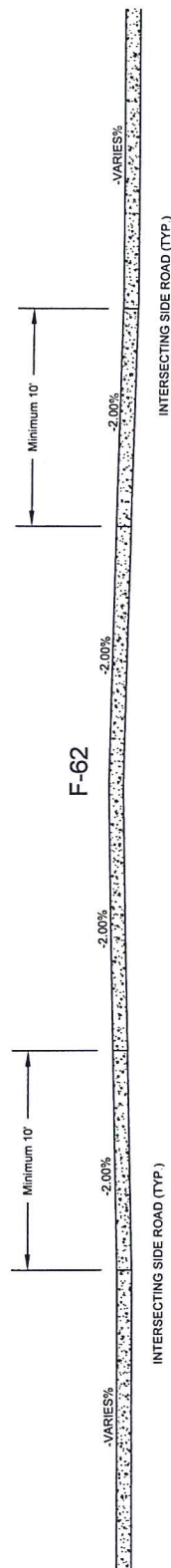

**SIDE ROAD INTERSECTION DETAIL**

SCALE: NOT TO SCALE

FOR RUN-OUTS AT SIDE ROADS  
SEE SHEETS C.03-C.08 FOR LOCATIONS

JASPER COUNTY ENGINEERING DEPARTMENT	
DESIGN FOR	
<b>PCC OVERLAY - UNBONDED</b>	
<b>TYPICAL CROSS SECTIONS</b>	
<b>AND DETAILS</b>	
DESIGNED BY	LAST REVISION
JL 06-14-19	JL 06-14-19
PROJECT NO.	
STBG-SWAP-C050(125)--FG-50	

# W 78TH ST S INTERSECTION DETAIL

**W 78TH ST S  
(EXISTING ROCK)**

FURNISH & PLACE 2" GRANULAR TAPER

FURNISH & PLACE 2" GRANULAR SHOULDERS ALONG RADII

FURNISH & PLACE 9" PCC

EXISTING SHOULDER

HWY F-62



( IN FEET )  
1 inch = 30 ft.

**NOTES**

1. LONGITUDINAL JOINTS SHALL BE "L"-1" OR "KT"-1" TRAVERSE JOINTS SHALL BE TYPE "C" JOINTS UNLESS OTHERWISE NOTED
2. THE ENGINEER SHALL REVIEW AND APPROVE ANY CHANGES TO THE SHOWN JOINT DETAIL PRIOR TO CONSTRUCTION
3. MAXIMUM JOINT SPACING SHALL BE 12 FEET. MINIMUM JOINT SPACING SHALL BE 2 FEET UNLESS APPROVED BY ENGINEER

ROAD NAME		PCC		HMA		GRAN SUBF		GRAN SHLD		MOD. SUBBASE	
(SY)	(CY)	D (IN)	TONS	D (IN)	TONS	D (IN)	TONS	D (IN)	TONS	D (IN)	CY
W 78TH ST S (N)	413	105	0	0	0	6-9	17	9	21	0	0

**INTERSECTION QUANTITIES**

ROAD NAME		PCC		HMA		GRAN SUBF		GRAN SHLD		MOD. SUBBASE	
(SY)	(CY)	D (IN)	TONS	D (IN)	TONS	D (IN)	TONS	D (IN)	TONS	D (IN)	CY
W 78TH ST S (N)	413	105	0	0	0	6-9	17	9	21	0	0

JASPER COUNTY ENGINEERING DEPARTMENT  
DESIGN FOR  
**PCC OVERLAY**  
**TYPICAL CROSS SECTIONS AND DETAILS**  
DESIGNED BY: JL 06-14-19  
DATE REVISION: JL 06-14-19  
PROJECT NO: STBG-SWAP-C050(125)-FG-50



# W 70TH ST S INTERSECTION DETAIL

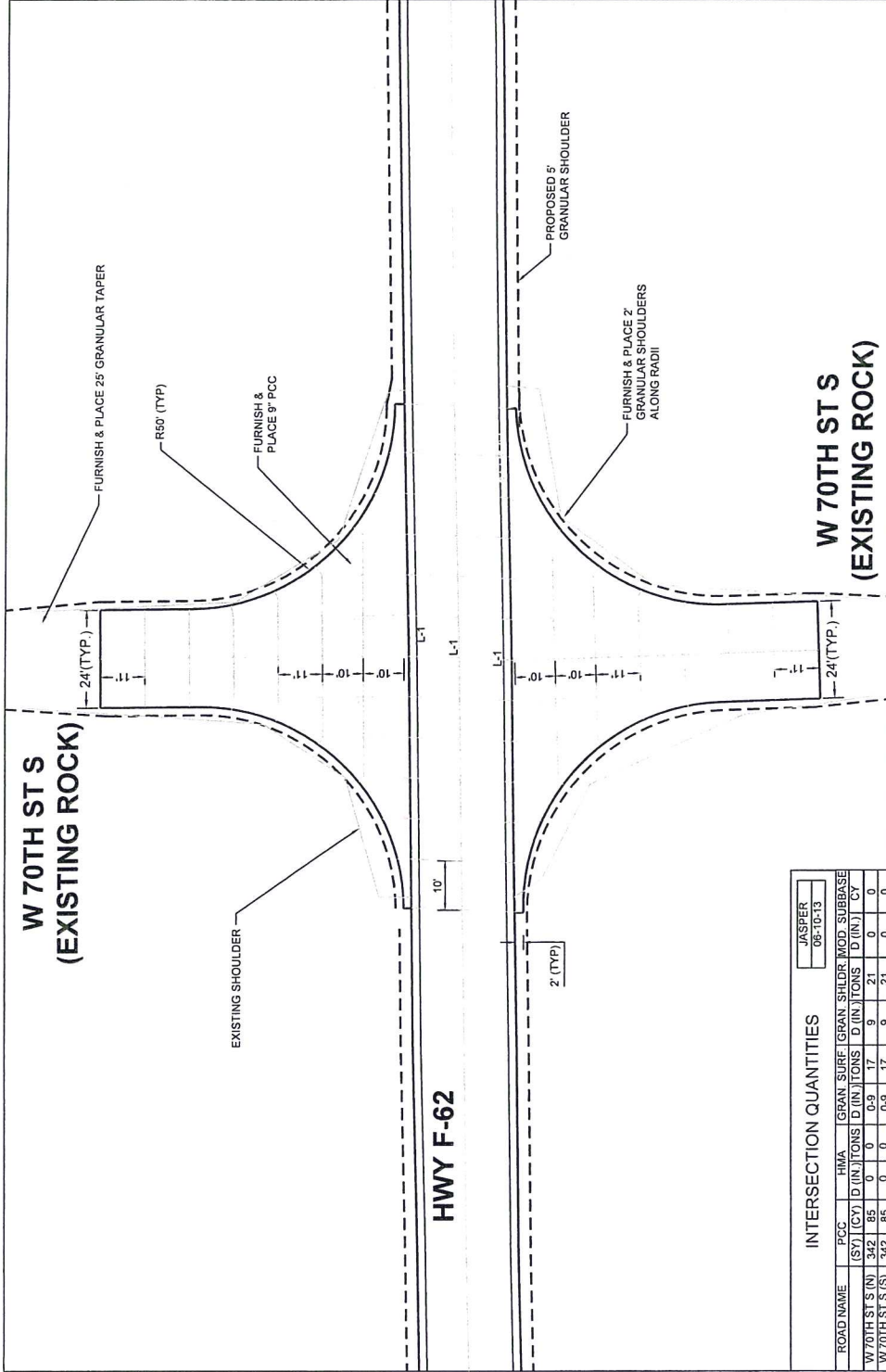

**NOTES:**

1. LONGITUDINAL JOINTS SHALL BE "L" OR "KT-1"; TRANSVERSE JOINTS SHALL BE TYPE "C" JOINTS UNLESS OTHERWISE NOTED
2. THE ENGINEER SHALL REVIEW AND APPROVE ANY CHANGES TO THE SHOWN JOINT DETAIL PRIOR TO CONSTRUCTION
3. MAXIMUM JOINT SPACING SHALL BE 12 FEET, MINIMUM JOINT SPACING SHALL BE 2 FEET UNLESS APPROVED BY ENGINEER



( IN FEET )  
1 inch = 30 ft.

INTERSECTION QUANTITIES		JASPER 06-10-13				
ROAD NAME	PCC (SY) (CY)	HMA D (IN.) TONS	GRAN. SURF. D (IN.) TONS	SHLDR D (IN.) TONS	MOD. SUBBASE D (IN.) TONS	CY
W 70TH ST S (N)	342	85	0	0	0	0
W 70TH ST S (S)	342	85	0	0	0	0

JASPER COUNTY ENGINEERING DEPARTMENT DESIGN FOR	
PCC OVERLAY	
TYPICAL CROSS SECTIONS AND DETAILS	
DESIGNED BY JL 06-14-19	CHECKED BY JL 07-03-19
PROJECT NO. STBG-SWAP-C050(125)-FG-50	

# W 62ND ST S INTERSECTION DETAIL

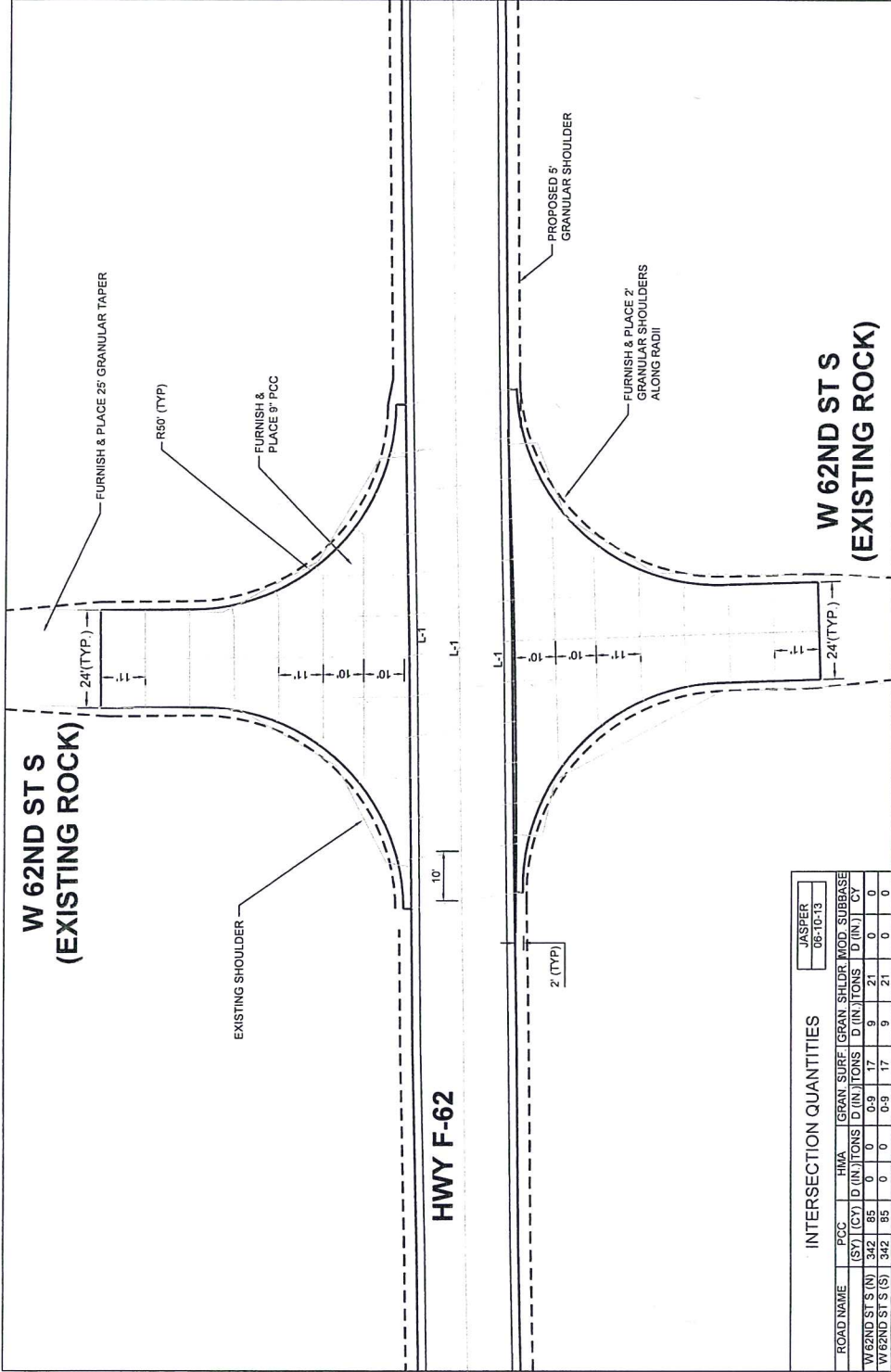

**NOTES:**

1. LONGITUDINAL JOINTS SHALL BE "L-1" OR "KT-1". TRANSVERSE JOINTS SHALL BE TYPE "C" JOINTS UNLESS OTHERWISE NOTED
2. THE ENGINEER SHALL REVIEW AND APPROVE ANY CHANGES TO THE SHOWN JOINT DETAIL PRIOR TO CONSTRUCTION
3. MAXIMUM JOINT SPACING SHALL BE 12 FEET. MINIMUM JOINT SPACING SHALL BE 2 FEET UNLESS APPROVED BY ENGINEER

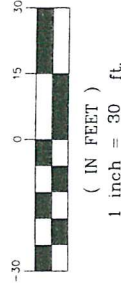

INTERSECTION QUANTITIES		JASPER COUNTY	
ROAD NAME	PCC	HMA	MOD. SUBBASE
(SY) (CY)	D (IN.)	TONS	D (IN.)
W62ND ST S (N)	342	85	0
W62ND ST S (S)	342	85	0

**W 62ND ST S  
(EXISTING ROCK)**

JASPER COUNTY ENGINEERING DEPARTMENT	
DESIGN FOR	
PCC OVERLAY	
TYPICAL CROSS SECTIONS AND DETAILS	
DESIGNED BY	JL 06-14-19
CHECKED BY	JL 07-03-19
PROJECT NO.	STBG-SWAP-C050(125)-FG-50



# W 56TH ST S INTERSECTION DETAIL

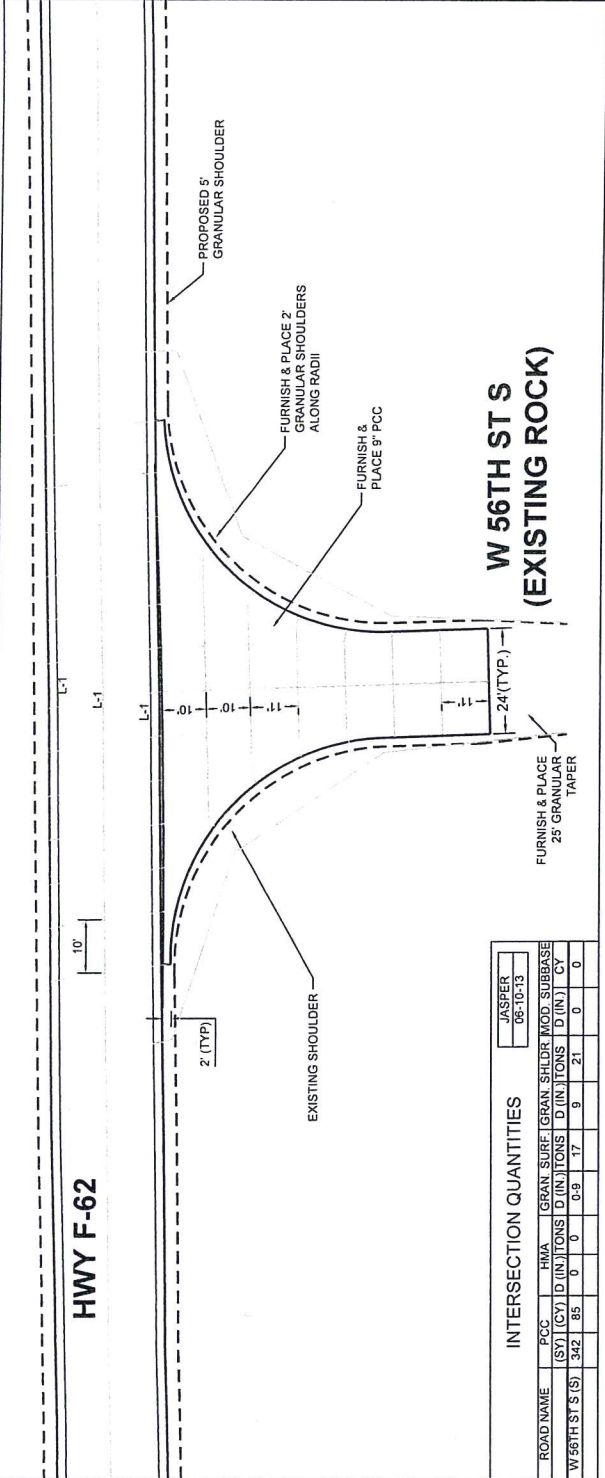

**NOTES**

1. LONGITUDINAL JOINTS SHALL BE "L-1" OR "KT-1" TRANSVERSE JOINTS SHALL BE TYPE "C" JOINTS UNLESS OTHERWISE NOTED
2. THE ENGINEER SHALL REVIEW AND APPROVE ANY CHANGES TO THE SHOWN JOINT DETAIL PRIOR TO CONSTRUCTION
3. MAXIMUM JOINT SPACING SHALL BE 12 FEET, MINIMUM JOINT SPACING SHALL BE 2 FEET UNLESS APPROVED BY ENGINEER

INTERSECTION QUANTITIES		JASPER 06-10-13						
ROAD NAME	PCC (CY) (S)	HMA (CY) (S)	GRAN. SURF. (CY) (S)	GRAN. (CY) (S)	SURF. (CY) (S)	SHLDR. (CY) (S)	MOD. (CY) (S)	SUBBASE (CY) (S)
W 56TH ST S (S)	342	85	0	0	0	0	0	0
			0-9	17	9	21	0	0

# CONCRETE DRIVEWAY JOINT DETAILS

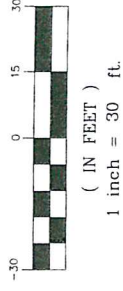
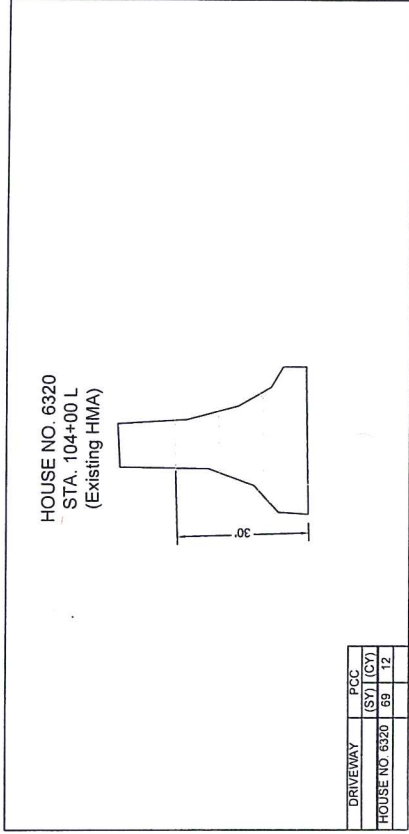

JASPER COUNTY ENGINEERING DEPARTMENT	
DESIGN FOR	
PCC OVERLAY	
TYPICAL CROSS SECTIONS AND DETAILS	
DESIGNED BY	JL 06-14-19
CHECKED BY	JL 07-03-19
PROJECT NO.	STBG-SWAP-C050(125)--FG-50

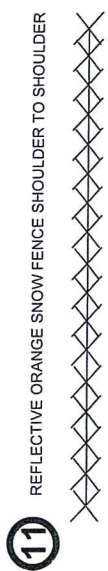
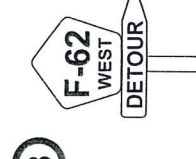
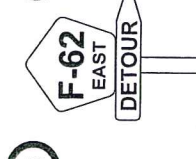
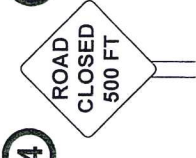
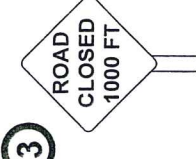
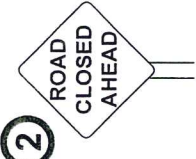
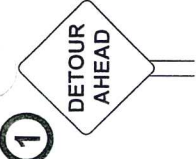

DETOUR ROUTE SIGNS  
SCALE: NOT TO SCALE

12

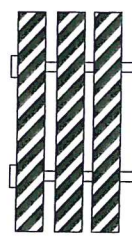

13

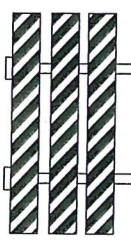

14

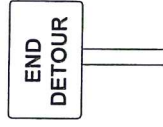

15



16



TABULATION	
1	3 EACH
2	6 EACH
3	1 EACH
4	1 EACH
5	1 EACH
6	1 EACH
7	2 EACH
8	1 EACH
9	3 EACH
10	6 EACH
11	2 EACH
12	7 EACH
13	1 EACH
14	2 EACH
15	1 EACH
16	3 EACH

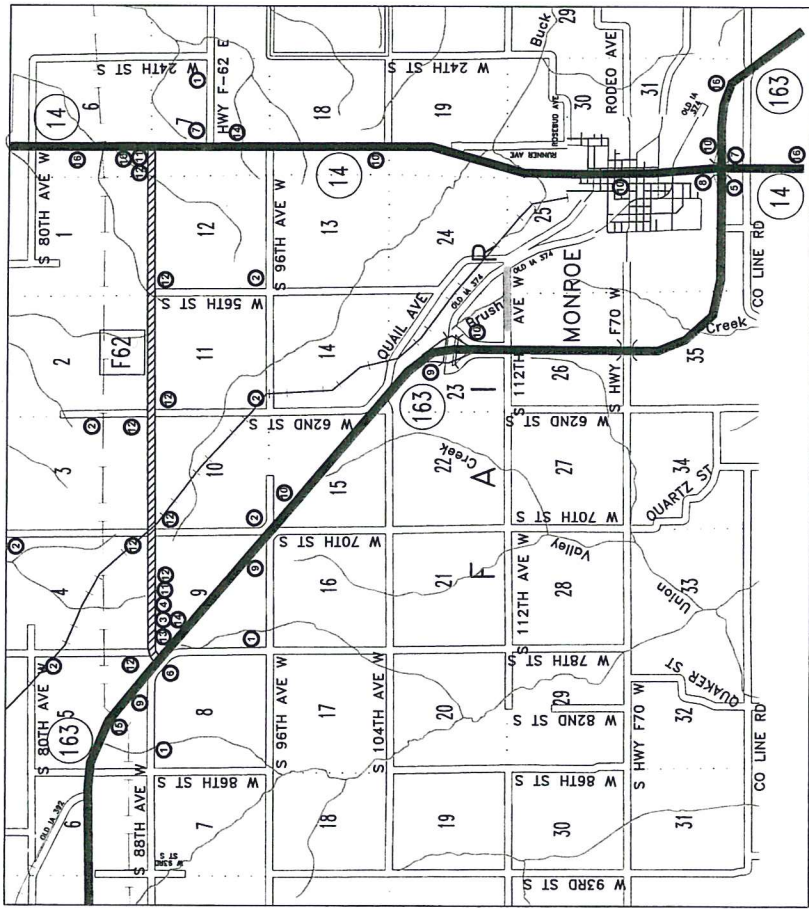

JASPER COUNTY ENGINEERING DEPARTMENT  
DESIGN FOR  
PCC OVERLAY - UNBONDED  
TRAFFIC CONTROL  
PLAN  
DESIGNED BY: JL 07-17-19  
DATE REVISED: JL 09-04-19  
PROJECT NO: STBG-SWAP-C050(125)-FG-50



STANDARD TYPES OF PAVEMENT MARKINGS

SCALE: NOT TO SCALE

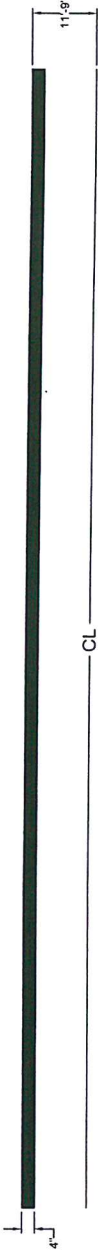

EDGE LINE  
WHITE

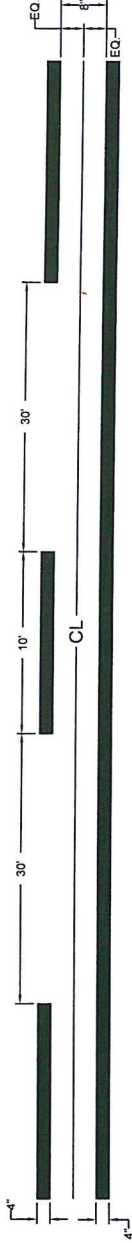

SINGLE NO-PASSING  
YELLOW

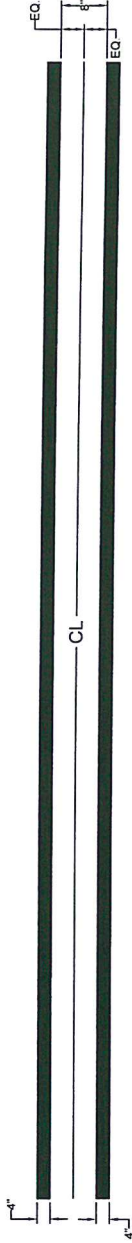

DOUBLE NO-PASSING  
YELLOW



BROKEN CENTERLINE  
YELLOW

JASPER COUNTY ENGINEERING DEPARTMENT  
DESIGN FOR

PCC OVERLAY - UNBONDED  
PAVEMENT MARKINGS

DATE: JL 07-17-19

PROJECT NO: STBG-SWAP-C050(125)-FG-50

DATE: JL 07-17-19

PROJECT NO: STBG-SWAP-C050(125)-FG-50